

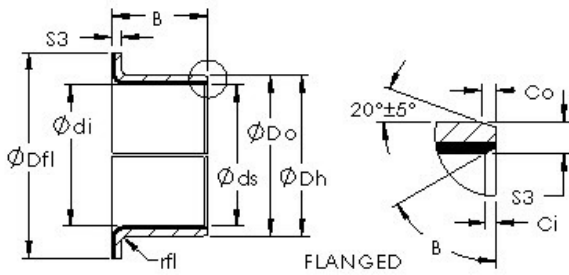

EKU Power Transmission Fittings Co., ...



AST AST50 14FIB16 plain bearings

Bearing No. AST50 14FIB16

Bore Diameter	22,225 mm
Bearing Type	flanged
Shaft Dia., Nominal (d)	0.8750
Shaft Size (ds) - 0.8741	0.8729
Housing Bore Dia. (Dh) - 1.0005	0.9997
Bearing Bore after Mounting (di) - 0.8775	0.8743
Average Clearance (Cd)	0.0024
Wall Thickness (S3)	0.063
Bearing Length, Nominal (B)	1.000
Bearing Length Tolerance (B tol.) - +.010 / -0.010	+0.010 / 0.010
OD Chamfer Length (Co)	0.026
ID Chamfer Angle (B deg.)	30
ID Chamfer Length (Ci)	0.019
Flange Dia. (Dfl pm 0.5)	1.200
Flange Thickness (Sfl)	0.064
Flange Radius (rfl)	0.040
Material	Carbon steel shell with PTFE / Fiber lining

AST50 14FIB16 Bearing 2D drawings and 3D CAD models